

Top 2000 TBI 7W (S, L)

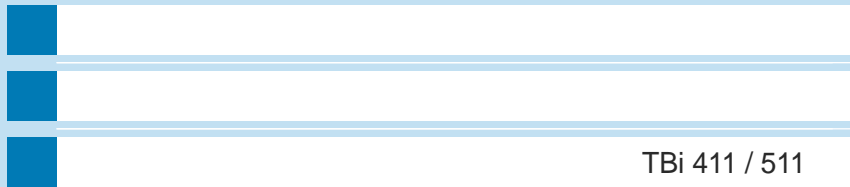
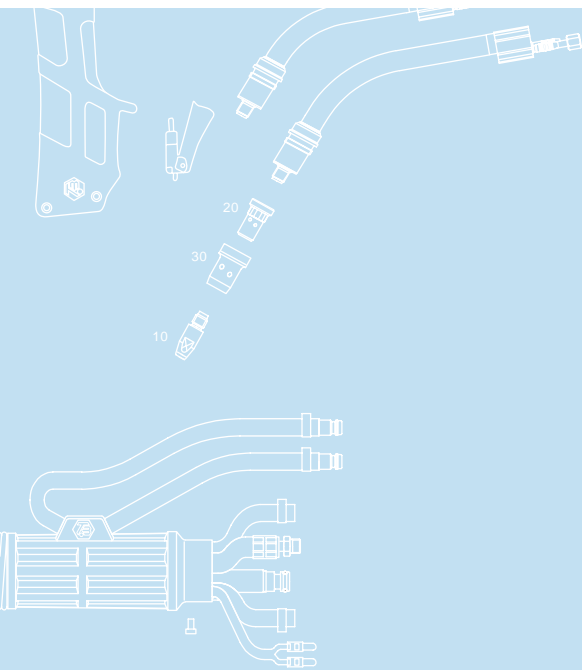

TBi 411 / 511

T i 7W-S	ESW,	50°	174PK425_0*
T i 7W-L	ESW,	50°	174PL425_0*
*		3, 4	5

		MIG/MAG TBI 7W (S, L)
(10 .)	100%	T i 7W-S: 400A, T i 7W-L: 450
- CO ₂ :	:	T i 7W-S: 450A, T i 7W-L: 500A
		1.0 - 1.6 mm
		15 /
		IEC 60974-7
1.5		1.60 kg
		(CLOOS®, ESAB®, Lincoln® .)



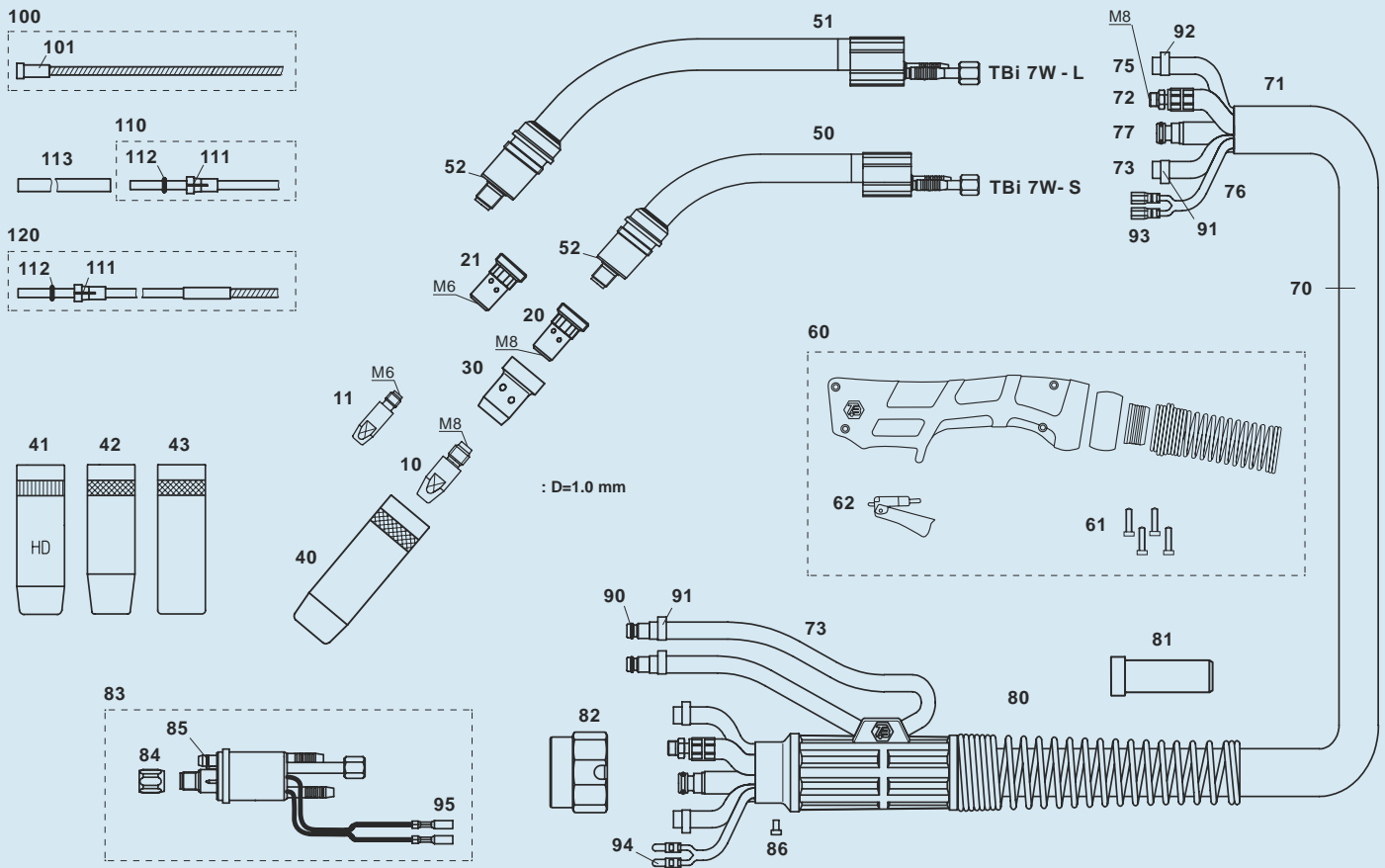

>	10	M8x30, ECU	340P_1262*
	10	M8x30, CuCrZr	340P_3262*
	10	M8x30 Alu, Ecu	341P_1262*
	11	M6x28, ECU	340P_1069*
	11	M6x28, CuCrZr	340P_3069*
	11	M6x28 Alu, ECU	341P_1069*

>	20	M8 / L=25 mm	342P008033
	20	CuCrZr M8 / L=25mm	342P008171
	20	M8 / L=29 mm	342P008133
	21	M6 / L=25 mm	342P006033
	21	M6 / L=29 mm	342P006133

>	30		130P002026
	30		130P002017
	30		130P002019
	30		130P002031

>	40	. NW 16.0 mm	345P022171
	41	. NW 16.0 mm HD	345P022271
	42	. NW 14.0 mm	345P023171
	43	. NW 19.0 mm	345P021171

	50	T i 7W-S (), 50°	174P101005
	51	T i 7W-L (), 50°	174P101006
	52		130P002004
	60		380P220401
	61	M3.5x14	100P008413

	62	, 2-	385P021016
	70	T i Top 2000, 2-K	171P4B45_0*
	71	25x1.5 mm,	307P2528_A*
	72	Top 2000,	316P1622_0*
	73	2-K, 5x1.5mm	303P070000
	75	PVC, 4.5x1.5 mm	302P010000
	76	(x.30 m)	301P2304_0*
	77	(Top 2000)	356P0C0C_0*
	80		701P101071
	81	70 qmm	600P002107
	82		701P001013
	83	ESW (Top 2000)	701P101006
	84	M10x1	701P002005
	85	4.0x1.0 mm	365P100040
	86	M4x6	100P008401
	90		701P002064
	91	O 9.5	373P100095
	92	O 8.7	371P000087
	93		375P000023
	94		375P000004
	95		375P000003

>	100	. (x.40 m) 1.0-1.2	322P2045_4*
	100	. (x.40 m) 1.4-1.6	322P2545_4*
	101	AD 4.5 mm	330P025045
	110	(x.50 m) 1.0-1.2	326P2040_5*
	110	(x.50 m) 1.2-1.6	326P2747_5*
	111	/ / 2.0x4.0mm	331P020040
	111	/ / 2.7x4.7mm	331P027047
	112	3.50x1.50 mm ()	365P150035
	113	5x4.4 mm, L=150 mm	329P544150
	120	ALU (x.50 m) 1.0-1.2	328P2040_A*
	120	ALU (x.50 m) 1.2-1.6	328P2347_A*
	120	ALU (x.50 m) 2.0-2.4	328P2947_A*

> =
* ,08 0,8 3 3 .